





13 801 670

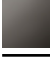

- 200mm projection
- rectangular normal flow
- hole diameter 37 mm
- 1/2" connection
- max. flow 25.1 l/min at 3 bar flow pressure

| | | |
|---|------------------|---------------|
|  | Brushed Chrome | 13 801 670-93 |
|  | Chrome | 13 801 670-00 |
|  | Brushed Platinum | 13 801 670-06 |
|  | Dark Chrome | 13 801 670-19 |
|  | Matte Black | 13 801 670-33 |

13 801 670

mm [inches]

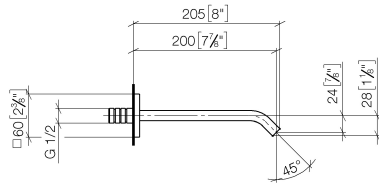

Flow rate chart

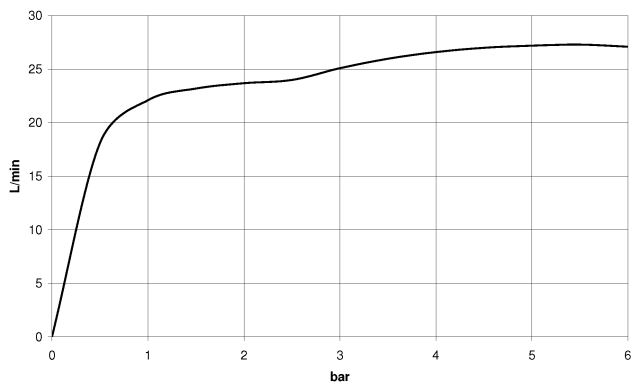

Codes & Standards

ASME
A112.18.1/CSA
B125.1



IMO Bath spout for wall mounting - Brushed Chrome

IMO

13 801 670

Certificates

IAPMO_4976 (2). WRAS_2005002.

13 801 670

Parts for other finishes can be found here: [Chrome](#)

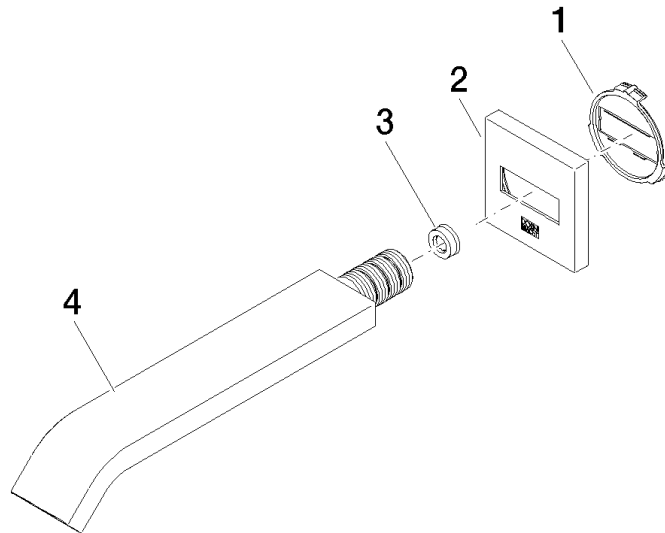

Spare parts list

| No. | Item Number | Name | Quantity used | Delivery time |
|-----|--------------------|--------------|---------------|---------------|
| 1 | 09 18 40 139 90 | base | 1 | 2 |
| 2 | 09 27 67 008-93 | rosette | 1 | 20 |
| 3 | 09 23 01 057 90 | flow reducer | 1 | 2 |
| 4 | 04 28 22 241 00-93 | spout | 1 | 20 |